



The new pinnacle of your elevator



Sigma head office
6F Two IFC, 10 Gukjegeumyung-ro,
Youngdeungpo-gu, Seoul 07326, Korea



ISO 9001
Certificate



ISO 14001
Certificate



ISO 50001
Certificate

Sigma constantly endeavors to improve products.
Please note that the information in this catalog is
subject to change without prior notice.

2023. 07 / Revision 1

Reaching new heights
<http://sigmaelevator.com>

SIGMA GLOBAL NETWORK

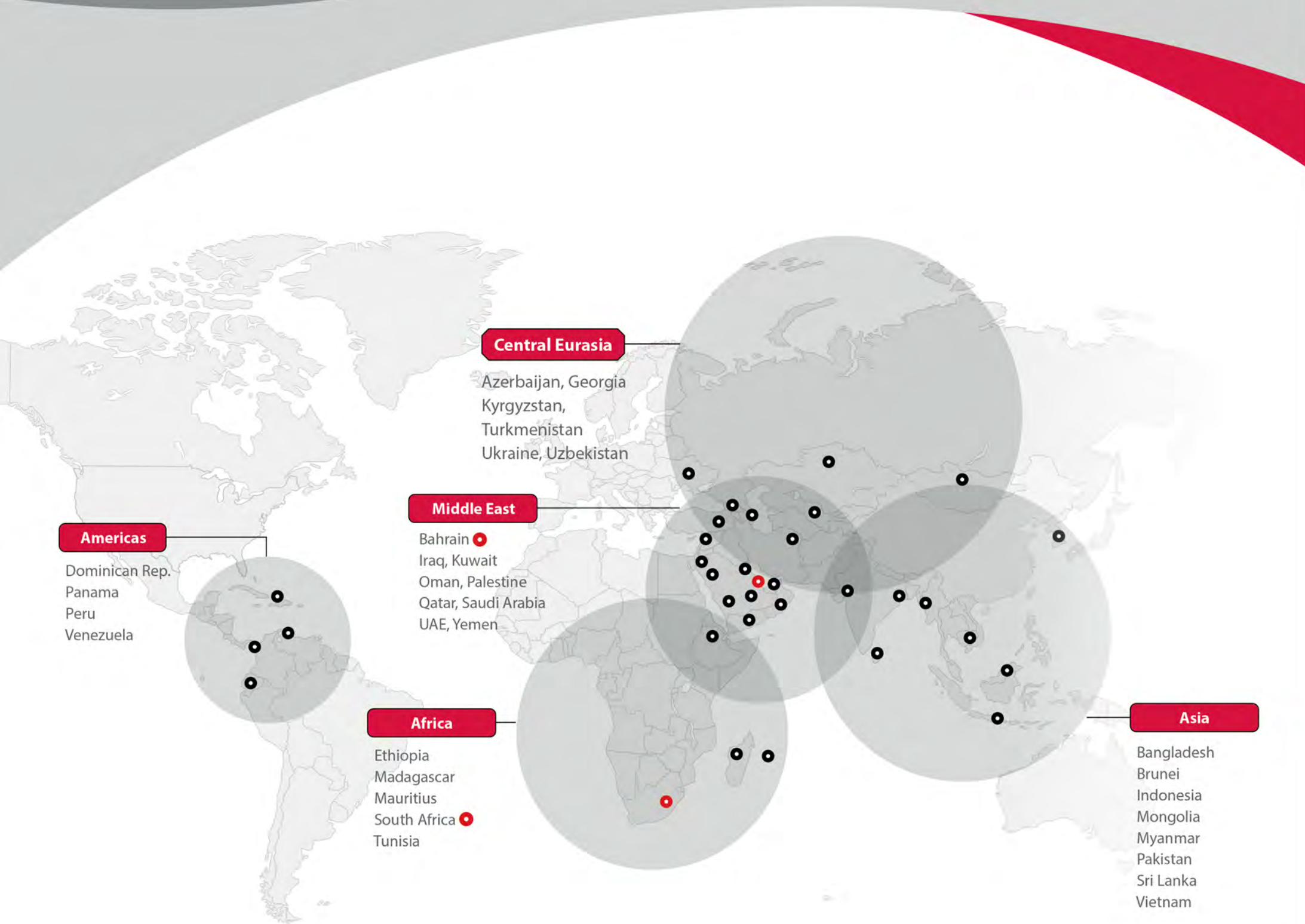

Sigma has exported over
160,000 elevators
worldwide since 1978





ISO 9001
Certificate



ISO 14001
Certificate



ISO 50001
Certificate

TOP-CLASS FACTORY

High tech factory with international accreditation enhances the competitiveness of the Sigma brand in the world.



Global engineered

The world's best engineers develop robust and optimized products through stringent quality verification system.

Qualified technology & products

Uniform and safe product supply according to Sigma's product development and proven parts supply process.

Korea flavored aesthetics

Providing trendy and practical products in collaboration with Korea Design Center.

Service excellence

Service excellence is beyond what we provide. It is how we think and act. It is not just "fixing a problem" or performing routine maintenance, but to provide prompt responses to every requests and passion for continuous improvement.

Reliability & Quality

Reliability and safety have been Sigma's foremost concerns. We are constantly pursuing to develop safer and reliable technologies for new products.

Sigma's elevators

ACRA 2.0 & SOLON 2.0

COMPACT MACHINE ROOM CONFIGURATION

The ACRA 2.0 elevator can be configured in a compact design that takes up no additional space beyond the hoistway, which not only reduces construction costs but also optimizes the use of rooftop area.

MACHINE ROOM-LESS CONFIGURATION

The SOLON 2.0 elevator requires only a hoistway as it features a compact machine and controller that fit inside it. This eliminates the need for a machine room to house the elevator components on top of the building, resulting in lower construction expenses and freeing up rooftop space.

ACRA 2.0

ACRA 2.0 is a machine room type elevator and it is most popular amongst Sigma products.



SOLON 2.0

SOLON 2.0 is an innovative roped type machine roomless mid-rise elevator with a highly efficient and compact PMSM (Permanent Magnet Synchronous Motor) gearless traction machine.

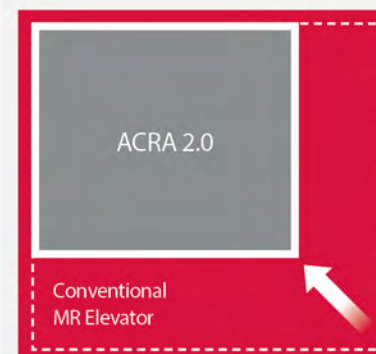

⊕ COMPACT DESIGN

Mini machine room technology eliminates machine room space and cost for greater architectural design freedom.

⊕ MAXIMIZED SPACE SAVINGS

Compact PMSM allows a smaller machine sheave, reducing machine size and raising efficiency.

Main Components

Traction Machine



ACRA 2.0
Compact PMSM



SOLON 2.0
Pencil machine
for Machine On Rail

- Globally designed and manufactured
- Lower vibration and better ride quality
- UCMP & ACOP certified
(Unintended Car Movement Protection)
(Ascending Car Overspeed Protection)
- Efficient and reliable performance
- More reliable and better EMC performance
- Lower brake noise

Main Safety Components



Safety gear

Sigma Standard
24 times of System Braking

EN81 Standard
3 times of System Braking



Overspeed governor

Sigma Standard
12 times of Dynamic Activation

EN81 Standard
3 times of Dynamic Activation



Oil buffer

Sigma Standard
100 times of Impact Test

EN81 Standard
2 times of Impact Test

Controller



OH-CON-MR



OH-CON-MRL

⊕ Environment Test

Temperature test	Dust test
Factory Standard -10 °C ~ 70 °C	Factory Standard 6000 g/m³
VS	VS
EN Standard +5 °C ~ 40 °C	EN Standard 6 g/m³

- ⊕ The industry-leading seal-star function to ensure safe rescue.
- ⊕ More silent, adopt noiseless contactor.
- ⊕ EMC compliance, non interference with other electromagnetic devices

Hygiene Innovation

New types of fixtures that provide innovative interface which fits the customers hygienic needs in protecting passengers from bacteria and virus exposure.

Gesture & Touchless

Key Benefits

Touchless

Easy installation

No need to use 3rd-party applications or tools

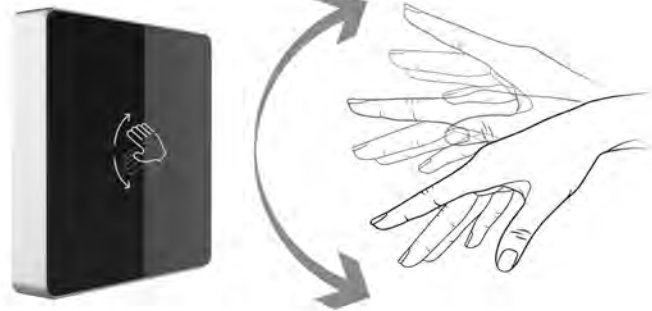

Gesture button

Registering floors from the landing without touching the button, using hand gestures



Touchless button

Registering floors without physically touching the button located next to the landing door by utilizing the sensor.

Air Purifier

An atom or group of atoms with negative electrical charge.

Positive ions produced by contaminated substances, dust, and bacteria can pollute the air. To maintain a clean and fresh atmosphere, anions counteract and eliminate these positive ions by neutralizing and settling them.

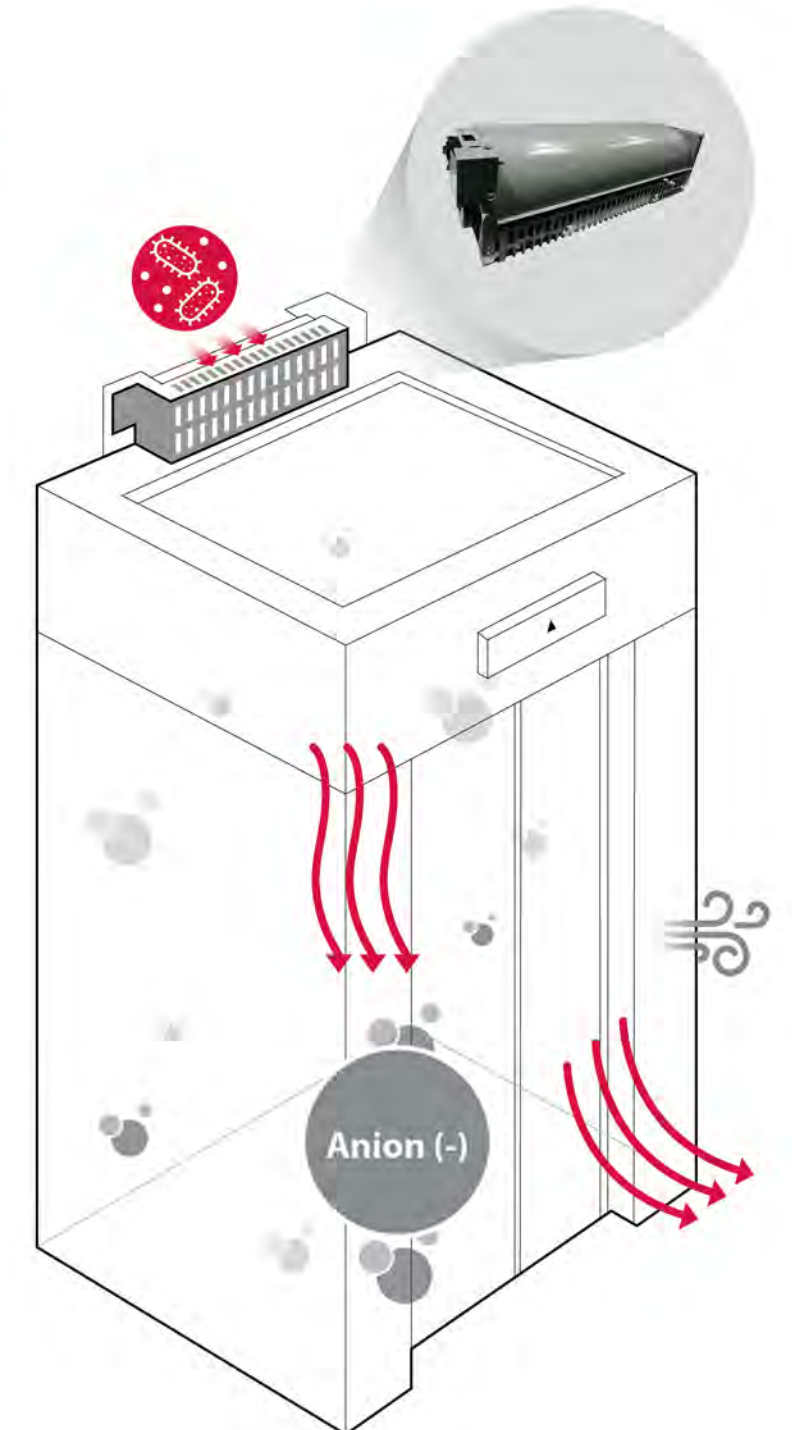

Improved ventilation

Exchanges the entire air in cab

>50 times/hour

Create a cleaner and healthier car environment



Classic

The Classic type is a timeless design that offers reliable and efficient performance. With its simple yet elegant style, it's the perfect choice for any building.

Cozy

The Cozy type is designed to provide a comfortable and inviting experience for passengers. Its warm lighting and plush interior make it the perfect choice for our customers.

Prestige

The Prestige type is the epitome of luxury and sophistication. Its sleek and modern design is sure to impress, and its advanced technology ensures a smooth and quiet ride.

Pinnacle

The Pinnacle type is the ultimate choice for customers that are meant to complement the overall architectural style of the building as well as giving passengers a riding comfort.



DESIGN

Classic 2201



Front View



Rear View

Specification

Ceiling	CS_L001 (RAL7038)
COP	COP09
CPI	LED5.5
COP Button	BR018B
Car Wall Finish	Front Panel · Pearl light champagne painted RAL140 Side Panel (from front to rear) · Pearl light champagne painted RAL140 Rear Panel (from left to right) · Pearl light champagne painted RAL140_MPL · White mirror patchwork · Pearl light champagne painted RAL140_MPL
Car Door Panel	Pearl light champagne painted RAL140
Handrail	49005_C 2 Side
Flooring	DE103

i The actual product can be different (changed) depending on design
Car wall image can be different (changed) depending on capacity

DESIGN

Classic 2202



Front View

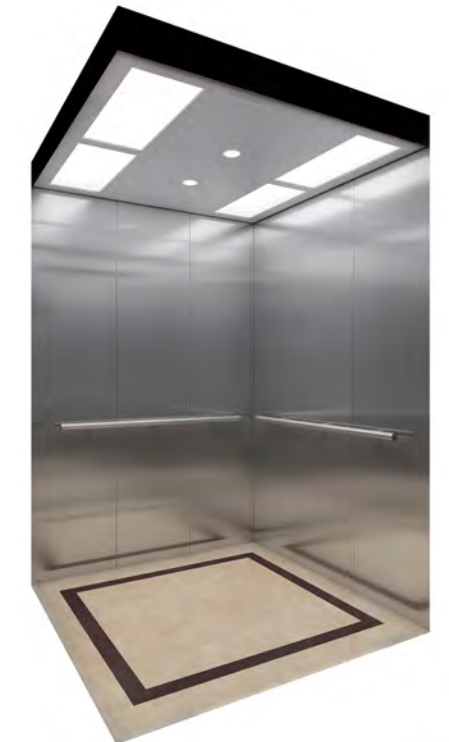

Rear View

Specification

Ceiling	CE209A (Hairline St.St)
COP	COP09
CPI	LED5.5
COP Button	BR018B
Car Wall Finish	Front Panel · Hairline St. St. Side Panel (from front to rear) · Hairline St. St. Rear Panel (from left to right) · Hairline St. St.
Car Door Panel	Hairline St. St.
Handrail	4900B_A 3 side
Flooring	DT03

i The actual product can be different (changed) depending on design
Car wall image can be different (changed) depending on capacity

DESIGN

Cozy 2203



Front View

Specification

Ceiling	CE_301 (Hairline St. St.)
COP	COP07
CPI	LED5.5
COP Button	BR016B
Car Wall Finish	Front Panel · Hairline St. St. Side Panel (from front to rear) · EW2-085 Etched Hairline St.St Rear Panel (from left to right) · EW2-085 Etched Hairline St.St
Car Door Panel	EH1-085 Etched Hairline St.St
Handrail	4900_A 3 Side
Flooring	DE313



Rear View

i The actual product can be different (changed) depending on design
Car wall image can be different (changed) depending on capacity

DESIGN

Cozy 2204



Front View

Specification

Ceiling	4605L (Mirror St.St)
COP	COP09A (Mirror St.St)
CPI	LED5.5
COP Button	BR018
Car Wall Finish	Front Panel · Mirror St. St. Side Panel (from front to rear) · Mirror St.St · EW4-034 Etched Mirror St.St · Mirror St.St. Rear Panel (from left to right) · Mirror St.St · EW4-034 Etched Mirror St.St · Mirror St.St.
Car Door Panel	EH3-034 Etched Mirror St.St
Handrail	4900R_B 3 Side
Flooring	DT03

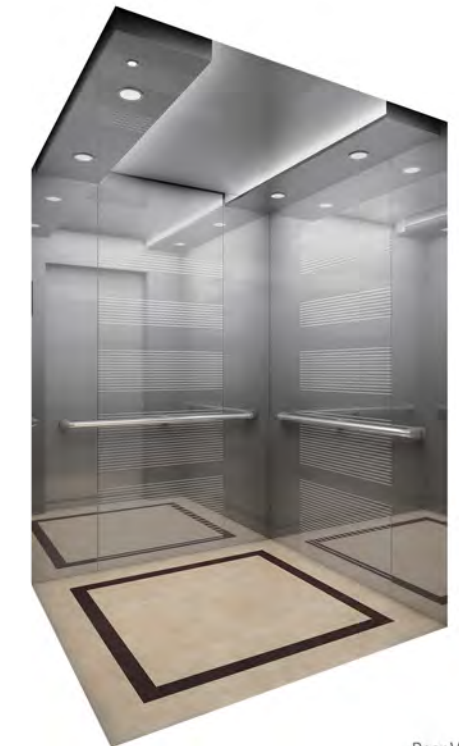

Rear View

i The actual product can be different (changed) depending on design
Car wall image can be different (changed) depending on capacity

DESIGN

Cozy 2205



Front View

Special Finish

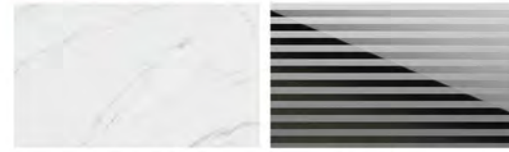

CG-10 White Marble
Stone Color Metal

SK-2 Etched
Mirror St.St

Specification

Ceiling	CE_301 (Mirror St.St)
COP	COP07 (Hairline St.St)
CPI	TFT7
COP Button	BR015
Car Wall Finish	Front Panel · Hairline St.St Side Panel (from front to rear) · CG-10 White Marble Stone Color Metal Rear Panel (from left to right) · Mirror St.St · SK-2 Etched Mirror St.St · Mirror St.St
Car Door Panel	Hairline St.St
Handrail	4900R_C 2 Side
Flooring	DT03



Rear View

1 The actual product can be different (changed) depending on design
Car wall image can be different (changed) depending on capacity

DESIGN

Cozy 2206



Front View

Special Finish



CG-4 Ebony Color Metal

Specification

Ceiling	4605L (Painted RAL7048PL)
COP	COP07 (Mirror St.St)
CPI	TFT7
COP Button	BR015B
Car Wall Finish	Front Panel · Hairline St.St Side Panel (from front to rear) · Hairline St.St · CG-4 Ebony Color Meta · Hairline St.St Rear Panel (from left to right) · Hairline St.St · Mirror St.St · Hairline St.St
Car Door Panel	EH1-085 Etched Hairline St.St
Handrail	4900_B 3 Side
Flooring	DE103



Rear View

1 The actual product can be different (changed) depending on design
Car wall image can be different (changed) depending on capacity

DESIGN

Cozy 2207



Front View

Special Finish



CG-4 Ebony
Color Metal

CG-5 Elegant White-
cloth Color Metal

Specification

Ceiling	CS-L001 (Painted RAL120_3)
COP	COP07 (Hairline St.St)
CPI	TFT7
COP Button	BR015
Car Wall Finish	Front Panel <ul style="list-style-type: none"> · Hairline St.St Side Panel (from front to rear) <ul style="list-style-type: none"> · Mirror St.St · CG-4 Ebony Color Metal · Mirror St.St Rear Panel (from left to right) <ul style="list-style-type: none"> · Mirror St.St · CG-5 Elegant White-cloth Color Metal · Mirror St.St
Car Door Panel	Hairline St.St
Handrail	4900_B 1 Side
Flooring	DE103



Rear View

i The actual product can be different (changed) depending on design
Car wall image can be different (changed) depending on capacity

DESIGN

Cozy 2208



Front View

Special Finish



RAL120_MPL Warm
Grey Pearl Painted Steel

CG-1 Burma Teak
Color Metal

Specification

Ceiling	CS-L001 (Painted RAL7038)
COP	COP07 (Hairline St.St)
CPI	LED5.5
COP Button	BR016
Car Wall Finish	Front Panel <ul style="list-style-type: none"> · Hairline St.St Side Panel (from front to rear) <ul style="list-style-type: none"> · Mirror St.St · RAL120_MPL Warm Grey Pearl Painted steel · Mirror St.St Rear Panel (from left to right) <ul style="list-style-type: none"> · Mirror St.St · CG-1 Burma Teak Color Metal · Mirror St.St
Car Door Panel	Hairline St.St
Handrail	4900_A 3 Side
Flooring	DE103



Rear View

i The actual product can be different (changed) depending on design
Car wall image can be different (changed) depending on capacity

DESIGN

Cozy 2209



Front View

Special Finish



RAL120_MPL Warm
Grey Pearl Painted Steel

CG-1 Burma Teak
Color Metal

Specification

Ceiling	CS-L001 (Painted RAL7038)
COP	COP09A (Hairline St.St)
CPI	LED5.5
COP Button	BR018B
Car Wall Finish	Front Panel · Hairline St.St Side Panel (from front to rear) · RAL120_MPL Warm Grey Pearl Painted steel · CG-1 Burma Teak Color Metal · RAL120_MPL Warm Grey Pearl Painted steel Rear Panel (from left to right) · RAL120_MPL Warm Grey Pearl Painted steel · STS MR RAL120_MPL Warm Grey Pearl Painted steel
Car Door Panel	Hairline St.St
Handrail	4900_A 3Side
Flooring	DE313



Rear View

1 The actual product can be different (changed) depending on design
Car wall image can be different (changed) depending on capacity

DESIGN

Prestige 2210



Front View

Special Finish



KB-19 Color Metal

Specification

Ceiling	4603L (Mirror St.St)
COP	COP09A (Hairline St.St)
CPI	LED5.5
COP Button	BR018B
Car Wall Finish	Front Panel · Hairline St.St Side Panel (from front to rear) · Mirror St.St · KB-19 Color Metal · KB-19 Color Metal Rear Panel (from left to right) · KB-19 Color Metal · Mirror St.St · KB-19 Color Metal
Car Door Panel	EH3-034 Etched Hairline St.St
Handrail	4900_A 3Side
Flooring	DT03



Rear View

1 The actual product can be different (changed) depending on design
Car wall image can be different (changed) depending on capacity

DESIGN

Prestige 2211



Front View

Special Finish



Champagne Gold
Hairline St.St

Champagne Gold
Mirror St.St

Specification

Ceiling	4603L (Champagne gold Mirror St. St.)
COP	COP09A (Hairline St.St)
CPI	LED5.5
COP Button	BR018B
Car Wall Finish	Front Panel · Hairline St.St Side Panel (from front to rear) · Champagne Gold Hairline St.St · Champagne Gold Mirror St.St · Champagne Gold Hairline St.St Rear Panel (from left to right) · Champagne Gold Hairline St.St · 2310 Champagne Gold Etched Mirror St.St · Champagne Gold Hairline St.St
Car Door Panel	Hairline St.St
Handrail	4900F 3 Side
Flooring	DT03



Rear View

i The actual product can be different (changed) depending on design
Car wall image can be different (changed) depending on capacity

DESIGN

Prestige 2212



Front View

Special Finish



CG-1 Burma Teak
Color Metal

Ti-Bronze Hairline St.St

Specification

Ceiling	CE_302 (Painted RAL7048PL)
COP	COP09A (Hairline St.St)
CPI	LED5.5
COP Button	BR018
Car Wall Finish	Front Panel · Hairline St.St Side Panel (from front to rear) · CG-1 Burma Teak Color Metal Rear Panel (from left to right) · Ti-Bronze Hairline St.St · 2311 Etched Mirror St.St. · Ti-Bronze Hairline St.St
Car Door Panel	Hairline St.St
Handrail	4900B_A 2 Side
Flooring	DT03

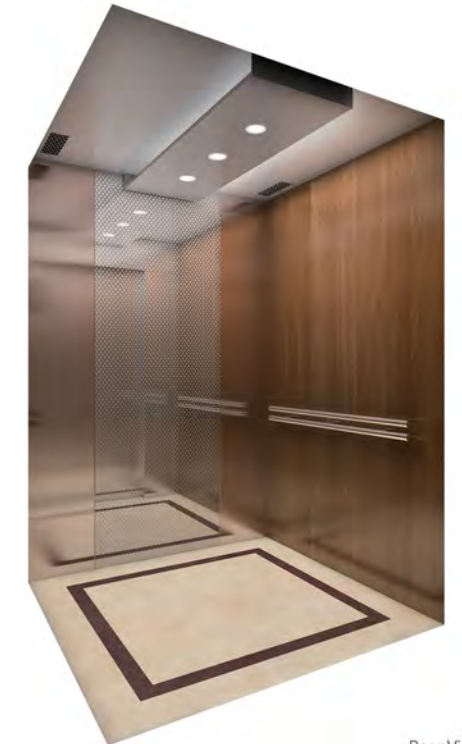

Rear View

i The actual product can be different (changed) depending on design
Car wall image can be different (changed) depending on capacity

DESIGN

Pinnacle 2213



Front View

Special Finish



Ti-Black
Hairline St.St

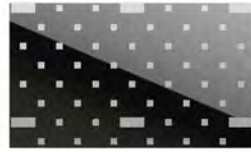

EW2-082 Ti-Black Etched
Mirror St.St

Specification

Ceiling 4604L (Painted RAL9005)

COP COP07 (Hairline St. St)

CPI TFT7

COP Button BR016B

Car Wall Finish

Front Panel

- Ti-Black Hairline St.St

Side Panel (from front to rear)

- Ti-Black Hairline St.St
- EW2-082 Ti-Black Etched Mirror St.St
- Ti-Black Hairline St.St

Rear Panel (from left to right)

- Ti-Black Hairline St.St
- EW2-082 Ti-Black Etched Mirror St.St
- Ti-Black Hairline St.St

Car Door Panel EH1-082 Ti-Black Etched Mirror St.St

Handrail 4900R_C 3 Side

Flooring DT01



Rear View

i The actual product can be different (changed) depending on design
Car wall image can be different (changed) depending on capacity

DESIGN

Pinnacle 2214



Front View

Special Finish



Ti-Bronze
Hairline St.St



CG-13 Cow Leather
Texture Color Metal

Specification

Ceiling CE_302 (Mirror St.St)

COP COP07 (Hairline St.St)

CPI LED5.5

COP Button BR016

Car Wall Finish

Front Panel

- Ti-Bronze Hairline St.St

Side Panel (from front to rear)

- Ti-Bronze Hairline St.St
- CG-13 Cow Leather Texture Color Metal
- Ti-Bronze Hairline St.St

Rear Panel (from left to right)

- Ti-Bronze Hairline St.St
- EW2-059 Etched Mirror St.St
- Ti-Bronze Hairline St.St

Car Door Panel EH1-059 Etched Mirror St.St

Handrail 4900R_B 3Side

Flooring DT03

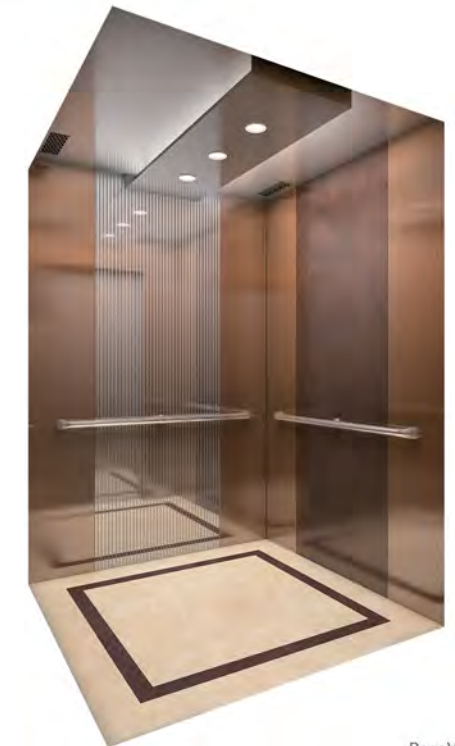

Rear View

i The actual product can be different (changed) depending on design
Car wall image can be different (changed) depending on capacity

DESIGN

Pinnacle 2215



Front View

Special Finish

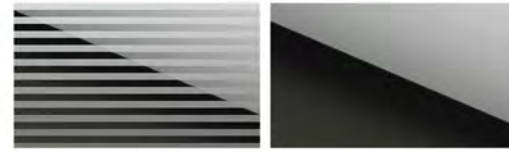

SK-2 Etched
Mirror St.St

Ti-black
Mirror St.St

Specification

Ceiling	4604L (Painted RAL9005)
COP	COP07 (Hairline St. St)
CPI	TFT7
COP Button	BR016B

Car Wall Finish

- Front Panel**
- Hairline St.St
- Side Panel (from front to rear)**
- Ti-black Mirror St.St
 - SK-2 Etched Mirror St.St
 - Ti-black Mirror St.St
- Rear Panel (from left to right)**
- Ti-black Mirror St.St
 - SK-2 Etched Mirror St.St
 - Ti-black Mirror St.St

Car Door Panel	Hairline St.St
Handrail	4900R_C 3 Side
Flooring	DT03



Rear View

i The actual product can be different (changed) depending on design
Car wall image can be different (changed) depending on capacity

DESIGN

Pinnacle 2216



Front View

Special Finish

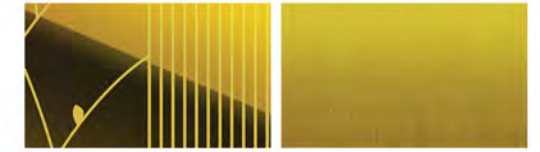

EW2-085 Ti-Gold
Etched Mirror St.St

Ti-Gold
Hairline St.St

Specification

Ceiling	4603L (Champagne gold Mirror St. St)
COP	COP09A (Hairline St.St)
CPI	LED5.5
COP Button	BR018B

Car Wall Finish

- Front Panel**
- Ti-Gold Hairline St.St
- Side Panel (from front to rear)**
- Ti-Gold Hairline St.St
 - EW2-085 Ti-Gold Etched Mirror St.St
 - Ti-Gold Hairline St.St
- Rear Panel (from left to right)**
- Ti-Gold Hairline St.St
 - EW2-085 Ti-Gold Etched Mirror St.St
 - Ti-Gold Hairline St.St

Car Door Panel	EH1-085 Ti-Gold Etched Mirror St.St
Handrail	4900R_E 3 Side
Flooring	DT01

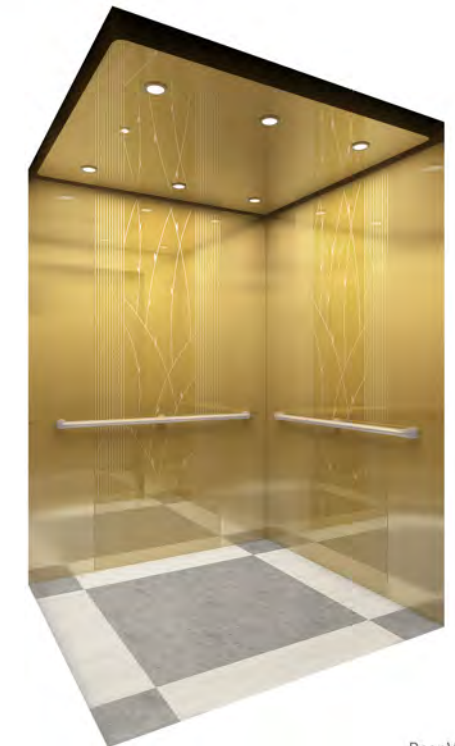

Rear View

i The actual product can be different (changed) depending on design
Car wall image can be different (changed) depending on capacity

DESIGN

Pinnacle 2217



Front View



Rear View

Special Finish



RAL9005 Black Matt
Painted Steel

RAL9003HL
Coagulation White
Highlights Painted Steel

Specification

Ceiling	4607L (Painted RAL7048PL)
COP	COP07 (Hairline St. St)
CPI	TFT7
COP Button	BR016B
Car Wall Finish	Front Panel <ul style="list-style-type: none"> · Hairline St.St Side Panel (from front to rear) <ul style="list-style-type: none"> · RAL9005 Black Matt Painted Steel · Ti-black Mirror St.St · Ti-black Mirror St.St Rear Panel (from left to right) <ul style="list-style-type: none"> · RAL9003HL Coagulation White Highlights Painted Steel
Car Door Panel	Hairline St.St
Handrail	4900_A 3Side
Flooring	DE313

Entrance



Type	J101 narrow jamb
Jamb Finish	Hairline St.St
Door Finish	Hairline St.St
Hall Fixtures	HF09_LED
Button	BR017



Type	J201 wide straight jamb with accentric line
Jamb Finish	Titanium Gold Mirror St.St
Door Finish	Titanium Gold Etched Mirror St.St (EH2-034)
Hall Fixtures	HF09_N
Hall Position Indicator	LED5.4_01
Button	BR018B

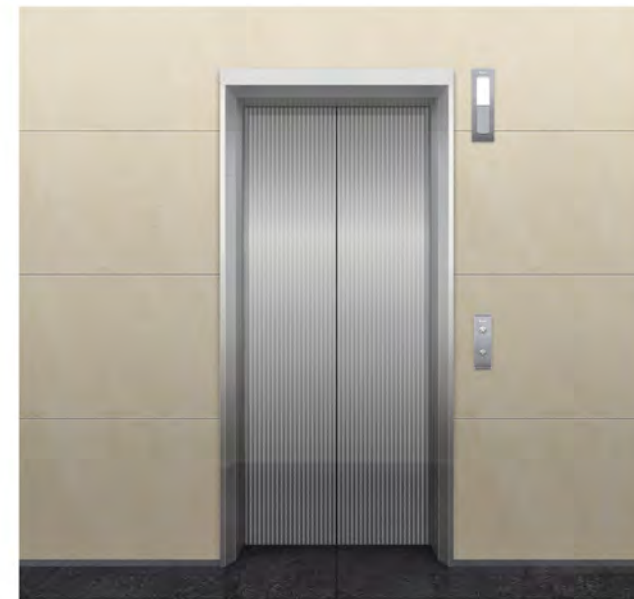

Type	J301 semi-taperd jamb with accentric line
Jamb Finish	Mirror Stainless Steel
Door Finish	Etched Mirror St.St (EH1-059)
Hall Fixtures	HF07_N
Hall Position Indicator	HL_07
Button	BR016B



Type	J401 full taperd jamb with accentric line
Jamb Finish	Hairline Stainless Steel
Door Finish	Etched Hairline St.St (EH1-085)
Hall Fixtures	HF07_N
Hall Position Indicator	LED5.4_01
Button	BR015B

i The actual product can be different (changed) depending on design
Car wall image can be different (changed) depending on capacity

i The actual product can be different (changed) depending on design

Etching

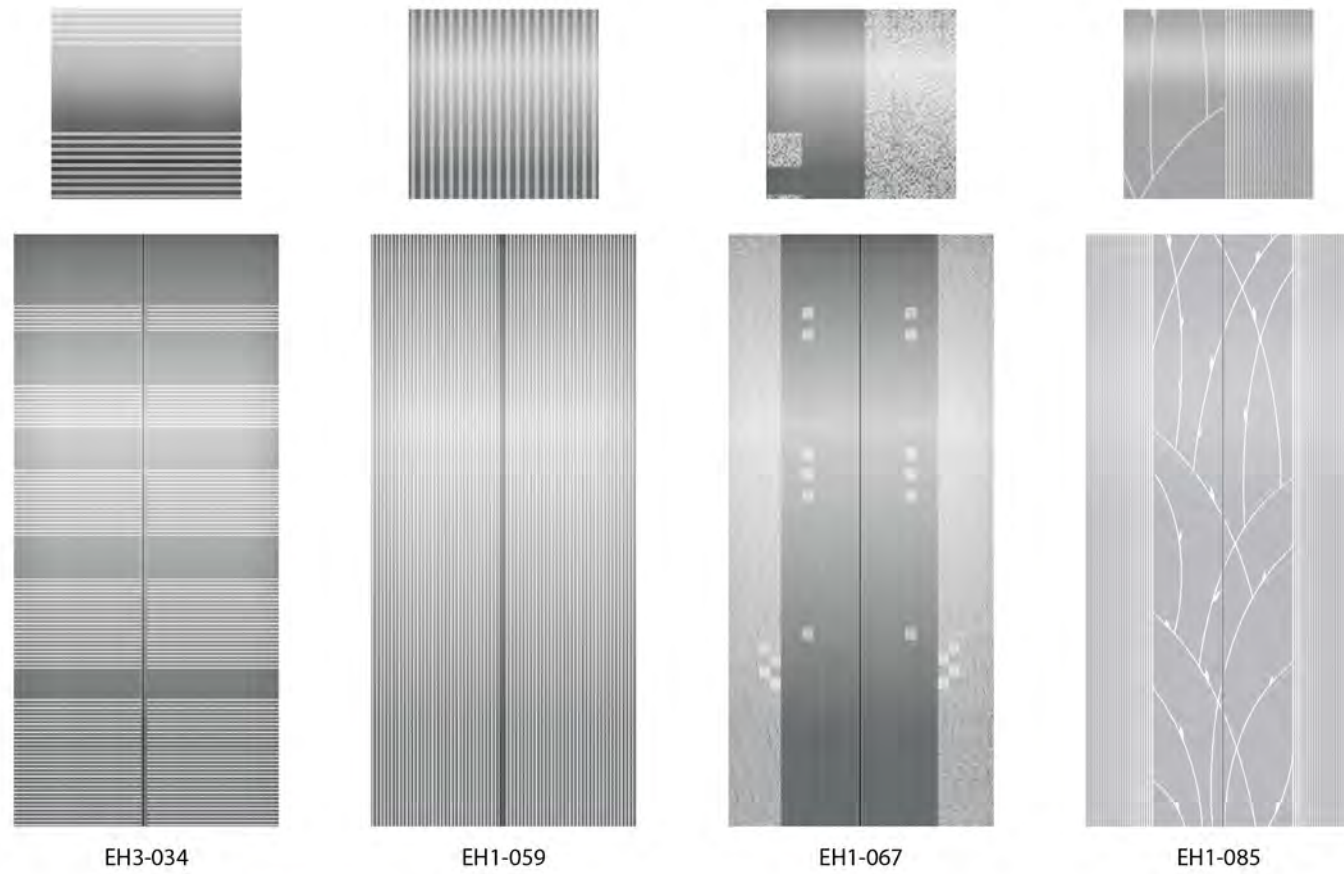

Paint



! The actual product can be different (changed) depending on design

Ceiling

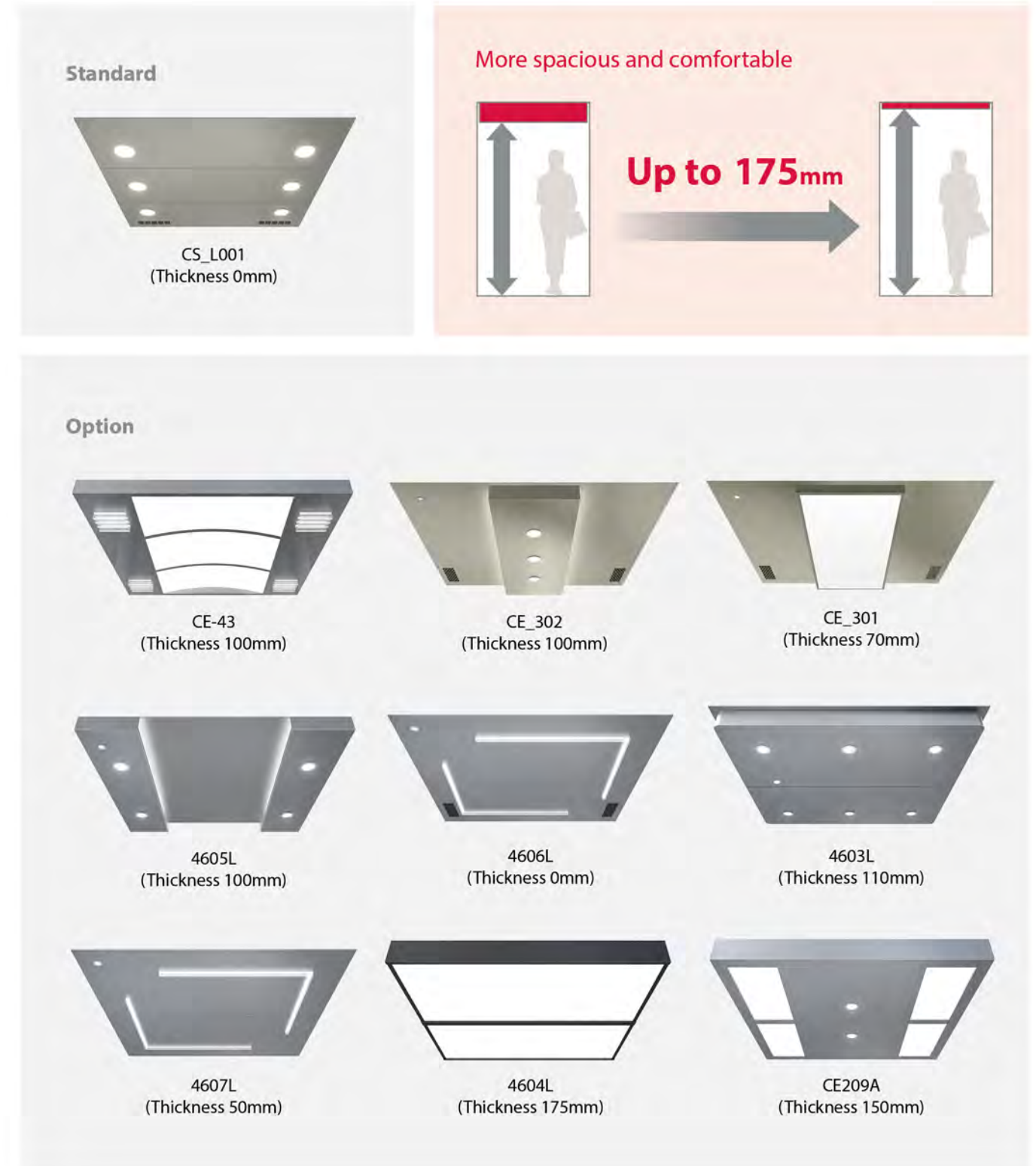

Handrails



Floorings(PVC)



FTYP09(Standard, LED Type)

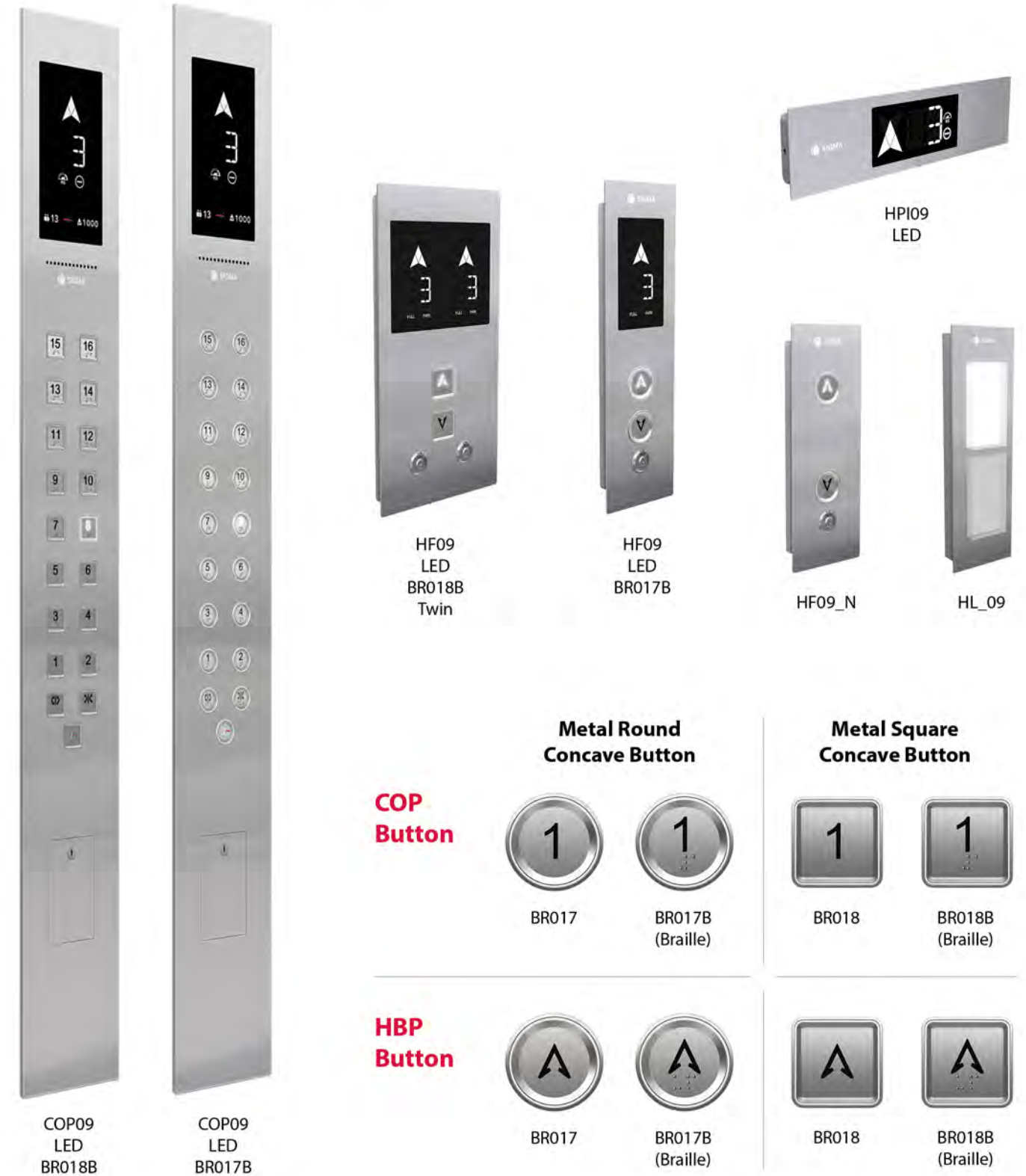

FTYP07(Option, LED & TFT Type)



Layout Drawing

[Hoistway Plan]

Rear Counterweight

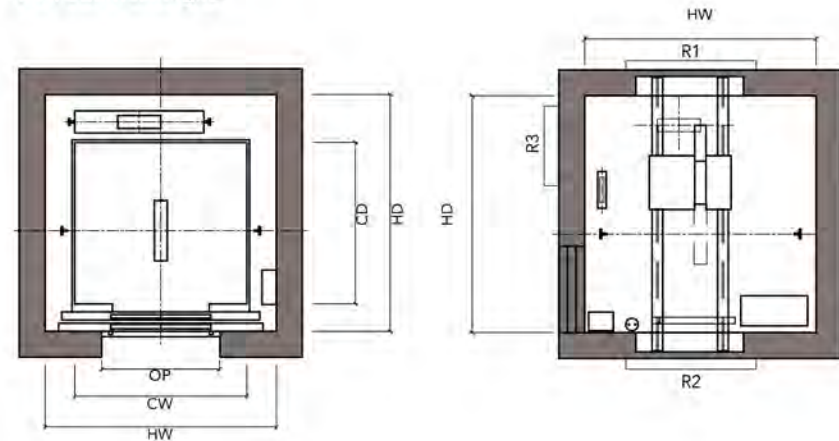

[Hoistway Plan]

Side Counterweight

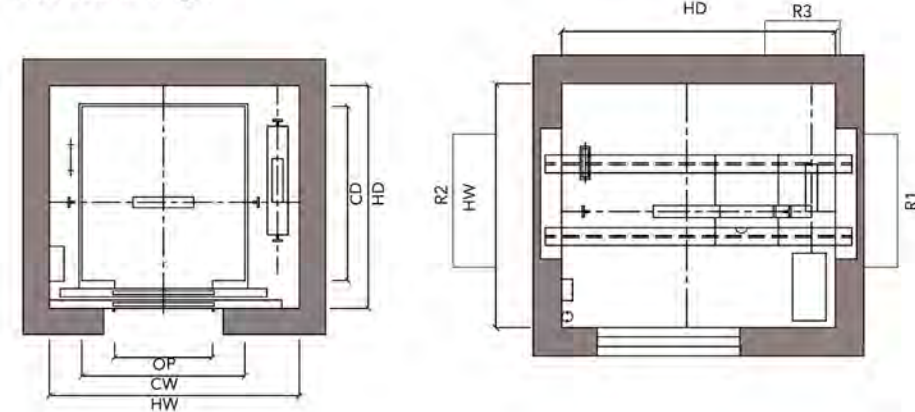

[Hoistway Section]

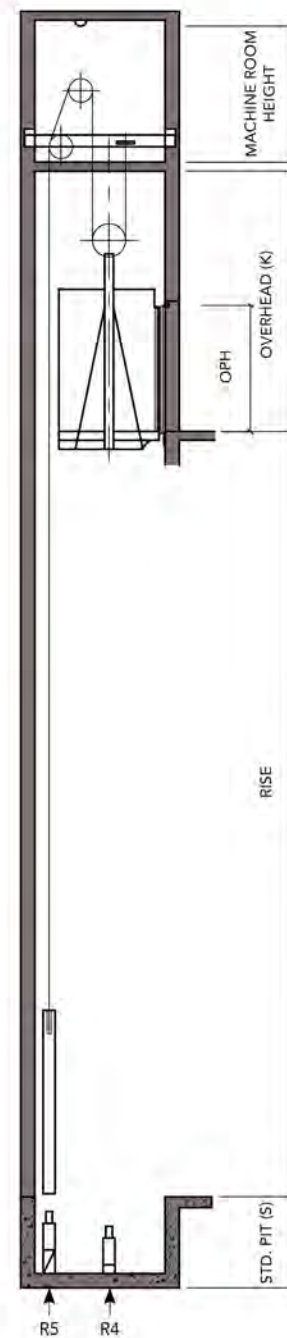

Layout Dimension

(Unit : mm)

Speed (m/s)	Capacity		Opening Width (mm)	Opening Type	Car Size		Hoistway Size		Machine Room Size		Reaction Load (N)					CWT Position					
	Person	Load(kg)			CW	CD	HW	HD	MW	MD	Machine Room			Pit							
												R1	R2	R3	R4	R5					
1-1.75	7	550	800	CLD	1200	1100	1900	1750	1900	2450	28.5	15.4	NA	63.3	52.8	Back					
	8	630	800		1300	1100	1900	1750	1900	2450	30.0	16.3	NA	68.0	55.8						
	9	680	800		1350	1150	1900	1800	1900	2500	31.6	17.2	NA	73.3	60.1						
	10	750	800		1400	1300	1900	1950	1900	2650	33.8	18.4	3.0	79.9	65.2						
	10	800	800		1400	1350	1900	2000	1900	2700	35.7	18.9	3.1	82.8	67.1						
	12	900	900		1500	1400	2000	2100	2000	2800	38.3	20.5	3.3	87.7	70.0						
	13	1000	900		1600	1450	2150	2200	2150	2900	39.1	21.4	3.4	93.0	72.2						
	14	1050	900		1600	1500	2150	2200	2150	2900	39.1	21.4	3.4	93.0	72.2						
	7	550	800		1200	1100	2050	1750	2750	1750	28.5	15.4	NA	63.3	52.8	Side					
	8	630	800		1300	1100	2100	1750	2800	1750	30.0	16.3	NA	68.0	55.8						
	9	680	800		1350	1150	2200	1800	2900	1800	31.6	17.2	NA	73.3	60.1						
	10	750	800		1400	1350	2200	1900	2900	1900	33.8	18.4	3.0	79.9	65.2						
	10	800	800		1400	1350	2200	1900	2900	1900	35.7	18.9	3.1	82.8	67.1						
	12	900	900		1400	1500	2200	1950	2900	1950	38.3	20.5	3.3	87.7	70.0						
13	1000	900	1450	1600	2300	2050	3000	2050	39.1	21.4	3.4	93.0	72.2								
14	1050	900	1500	1600	2300	2050	3000	2050	39.1	21.4	3.4	93.0	72.2								
2.0-2.5	10	800	800	1400	1350	1950	2000	1950	2700	20.5	40.5	20.0	87.5	72.1	Back						
	12	900	900	1500	1400	2000	2100	2000	2800	22.4	44.5	22.1	91.6	74.2							
	13	1000	900	1600	1450	2150	2200	2150	2900	51.3	27.1	5.9	107.3	86.8							
	14	1050	900	1600	1500	2150	2200	2150	2900	51.3	27.1	5.9	107.3	86.8	Side						
	10	800	800	1400	1350	2200	1900	2900	1900	42.9	22.6	4.9	87.5	72.1							
	12	900	900	1400	1500	2200	1950	2900	1950	46.0	24.3	5.3	91.6	74.2							
	13	1000	900	1450	1600	2300	2050	3000	2050	51.3	27.1	5.9	107.3	86.8							
	14	1050	900	1500	1600	2300	2050	3000	2050	51.3	27.1	5.9	107.3	86.8							

Overhead, Pit & Machine Room Height

Speed(m/s)	Load(kg)	Overhead(mm)	Pit Depth(mm)	Machine Room Height(mm) CWT Back / Side
1.0	550~1050	4150	1350	2300 / 2500
1.5		4350	1400	
1.75		4450	1450	
2	800~1050	4550	1600	2500 / 2700
2.5		4800	1850	

Based on: RECES=3;CH=2400;
 When V<2m/s : CARRUNBY=200,CWTRUNBY=200;
 When V>=2m/s : CARRUNBY=250,CWTRUNBY=250;

Power Supply Plan

(380V)

Speed (m/s)	Capacity		Rated Power Capacity (kW)	Elevator Current (A)		Heat Dissipation (kcal/H)
	Person	Load(kg)		Rated	Starting	
1.0	7	550	6.1	11.7	18.8	743
	8	630	6.7	12.7	20.1	798
	9	680	7.1	13.4	21.8	849
	10	750	7.5	14.3	22.6	909
	10	800	7.9	15.0	23.4	953
	12	900	8.6	16.3	26.0	1,027
	13	1000	9.3	17.6	27.7	1,087
	14	1050	9.7	18.3	28.6	1,147
1.5	7	550	7.9	13.5	21.0	846
	8	630	8.9	16.9	29.2	999
	9	680	9.4	17.9	30.8	1,055
	10	750	10.1	19.2	32.8	1,130
	10	800	10.6	20.2	34.0	1,181
	12	900	11.6	22.1	36.8	1,283
	13	1000	12.7	24.1	38.5	1,394
	14	1050	13.2	25.0	39.6	1,448
1.75	7	550	9.2	15.2	26.8	974
	8	630	10.0	19.0	34.2	1,122
	9	680	10.6	20.2	35.9	1,185
	10	750	11.5	21.8	38.3	1,269
	10	800	12.1	22.9	39.7	1,326
	12	900	13.2	25.0	41.9	1,427
	13	1000	14.4	27.3	44.2	1,563
	14	1050	15.0	28.4	45.5	1,611
2.0	10	800	14.4	27.3	47.5	1,462
	12	900	15.6	29.7	50.4	1,527
	13	1000	17.0	32.4	55.0	1,700
	14	1050	17.7	33.7	56.4	1,766
2.5	10	800	17.0	32.2	58.5	1,646
	12	900	18.6	35.4	64.2	1,739
	13	1000	20.3	38.6	69.6	1,905
	14	1050	21.2	40.2	71.5	1,978

Layout Drawing

[Hoistway Plan]

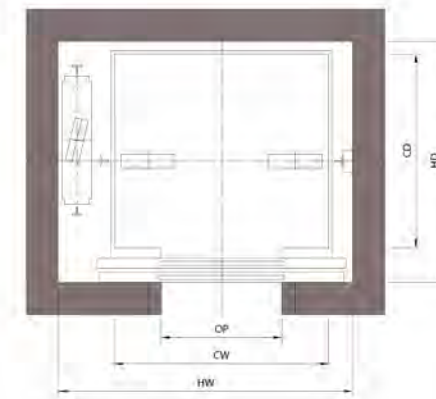

[Hoistway Section]

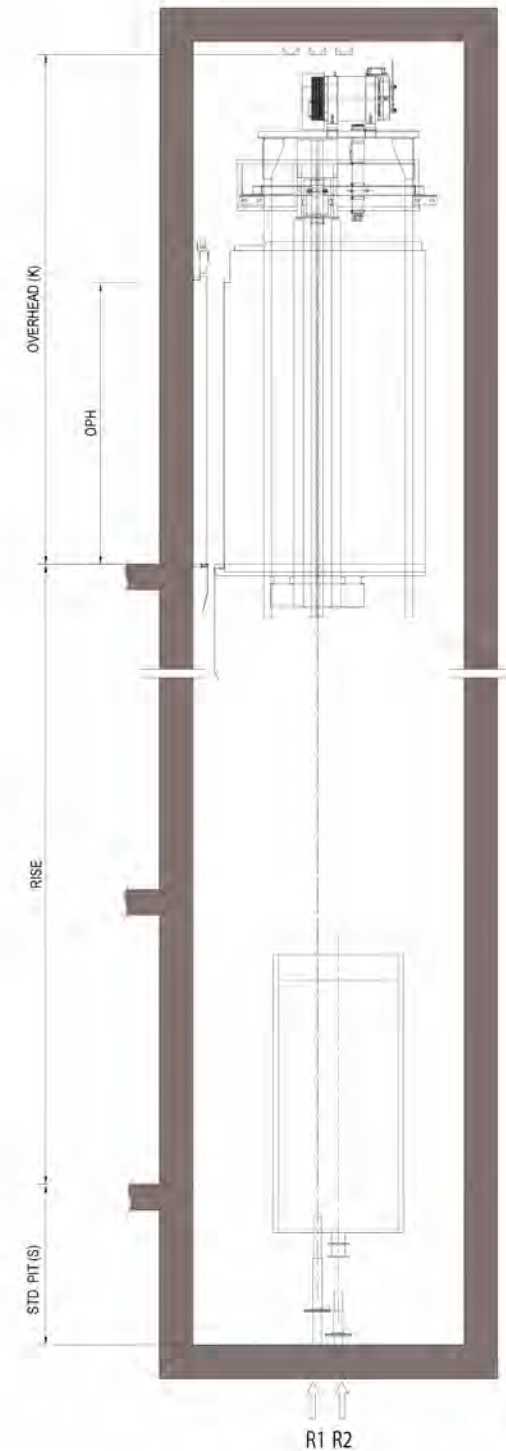

Layout Dimension

(Unit : mm)

Speed (m/s)	Capacity		Opening Width (mm)	Opening Type	Car Size		Hoistway Size		Reaction Load (N)	
	Person	Load(kg)			CW	CD	HW	HD	Pit	
									R1	R2
1.0-1.75	8	630	800	CLD	1100	1400	1850	1775	71.3	58.5
	10	800	800		1350	1350	1950	1700	80.4	64.1
	12	900	800		1500	1400	2100	1775	87.4	69.1
	13	1000	900		1600	1450	2200	1800	94.1	72.7
	14	1050	900		1600	1450	2200	1800	94.1	72.7

Overhead, Pit

Speed(m/s)	Capacity (kg)	Overhead(mm)	Pit Depth (mm)
1.0	630-1050kg	4050	1250
1.5		4250	1300
1.75		4350	1400

Standard S & K is based below configure: RECES=3; CH=2400;
 When V=1m/s : CARRUNBY=150,CWTRUNBY=150;
 When 1m/s < V <= 1.75m/s : CARRUNBY=200,CWTRUNBY=200

Power Supply Plan

(380V)

Speed (m/s)	Capacity		Rated Power Capacity (kW)	Elevator Current (A)		Heat Dissipation (kcal/H)
	Person	Capacity(kg)		Rated	Starting	
1.0	8	630	7.1	12.6	17.8	1,027
	10	800	8.4	15.0	20.7	1,257
	12	900	9.1	16.3	22.4	1,339
	13	1000	9.3	17.5	23.4	1,374
	14	1050	9.6	18.2	24.0	1,438
1.5	8	630	8.9	16.5	24.1	1,178
	10	800	10.7	19.9	27.7	1,461
	12	900	11.5	21.6	29.9	1,488
	13	1000	12.5	23.6	32.1	1,642
	14	1050	13.0	24.5	33.1	1,719
1.75	8	630	10.1	18.6	27.4	1,359
	10	800	12.2	22.5	31.7	1,690
	12	900	13.1	24.5	34.2	1,722
	13	1000	14.3	26.8	36.9	1,901
	14	1050	14.9	28.0	38.0	1,991

Narrow Jamb

[Plan View of Entrance]

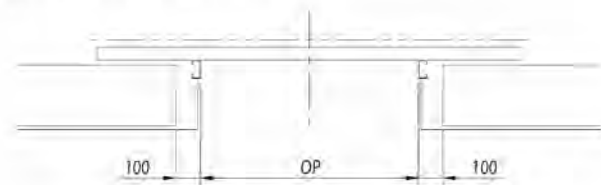

[Front View of Entrance]

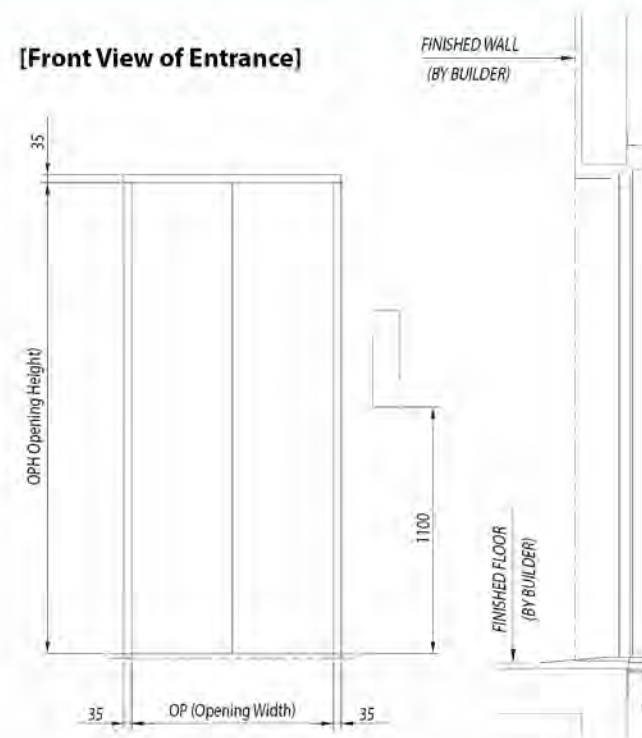

Wide Tapered Jamb with Transom panel

[Plan View of Entrance]

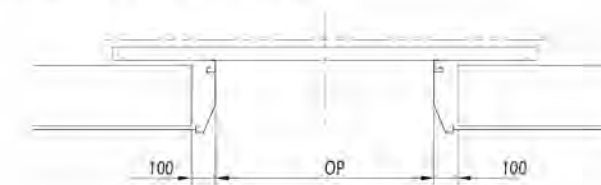

[Front View of Entrance]

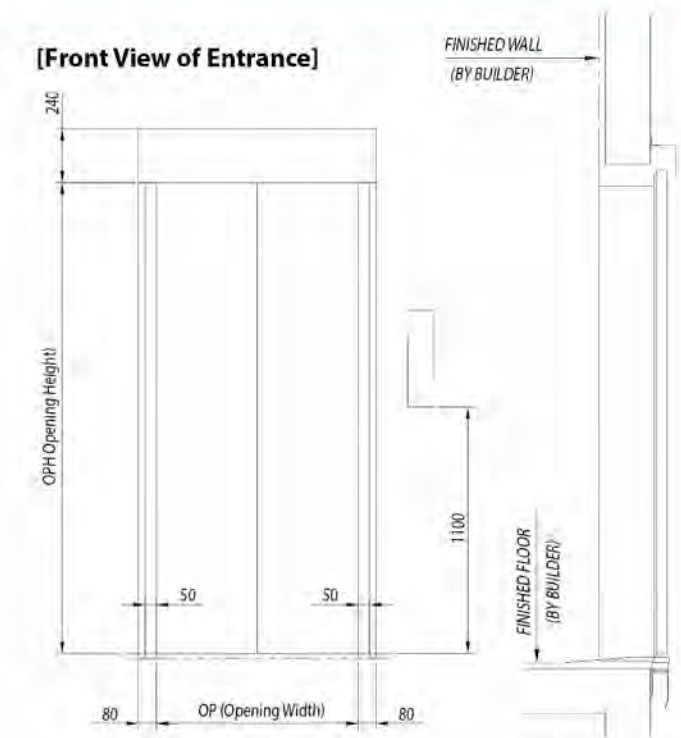

Narrow Jamb (SOLON 2.0 & Top Floor)

[Plan View of Entrance]

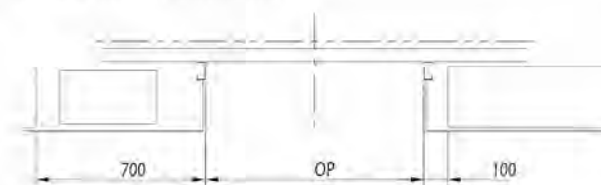

[Front View of Entrance]

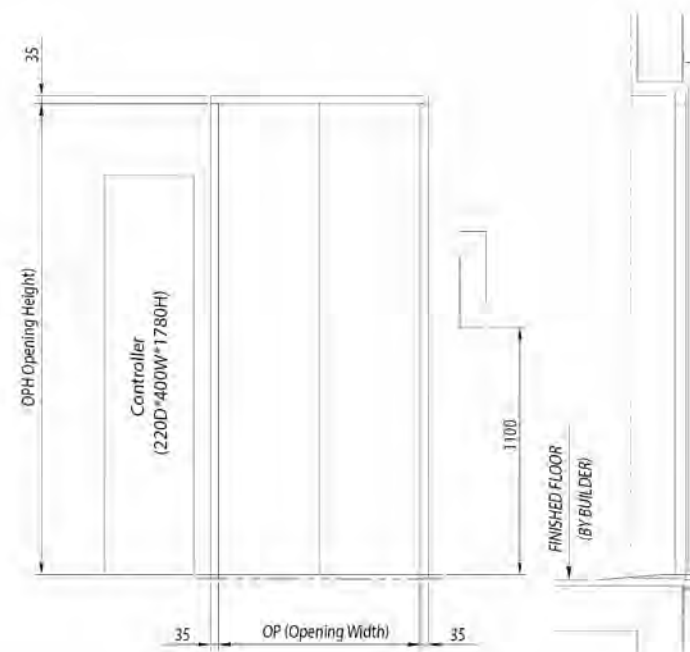

Wide Straight Jamb with Transom panel

[Plan View of Entrance]

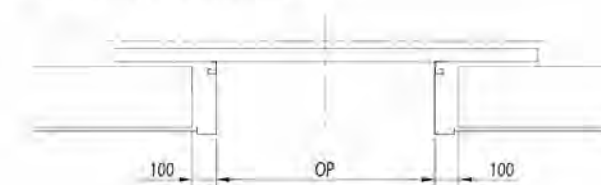

[Front View of Entrance]

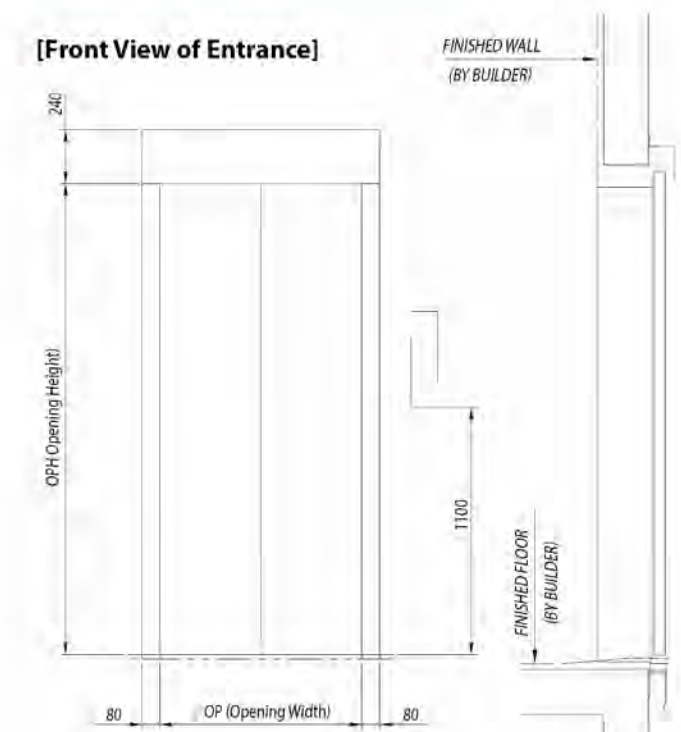

Note

1. Landing door facade dimension for each floor which wide jamb installed must be same value.
2. Wall thickness for wide jamb (including decoration) for each floor which wide jamb installed must be same value.

Note

1. Landing door facade dimension for each floor which wide jamb installed must be same value.
2. Wall thickness for wide jamb (including decoration) for each floor which wide jamb installed must be same value.

Available Functions_ACRA 2.0

Standard							
ACP Anti Crime protection	ADO Advanced Door Open	ALARB Alarm bell	ALCOR Advanced Releveling	CCC Car call cancellation	CFT Cafeteria mode	EDP Electronic door protection	CSP Close Torque protection
CUT CALL Block floor	DCBL/ DOBL Door close/open button light	DCP Delayed car protection	DDT Independent car/landing door control	DLM Door lock shortcut measure	DOB/DCB Door open/close button	DTC Door time protection -close	DTO Door time protection -open
ELTU Emergency Light	EN-CCO Call opposition direction cancel	EN-HCC Hall call cancel	ERO Electrical recall operation	FCL Full collective operation	HDI/CDI Hall/Car direction indicator	HPI/CPI Hall/car position indicator	ICU3 Intercom unit
LNS Load non stop	LOBBY Floor of lobby	LR Car light & ventilation	LWS Overload protection	NTSD Near terminal slow down	OHT Drive overheat protection	PKS Parking operation	RLEV Releveling
RE-OP Hall door re-open	RIN Re-initialize	SE Start Equalize	SELF-BTI Self brake torque inspection	SLD Safety landing	TCI Top of car inspection	VSC Voice speech comfort	UCMP Uncontrolled car movement protection

Optional							
ANS Anti-Nuisance	ARO Automatic Rescue Operation	ATT Attendant service	ISC Independent service	DHB Door hold button	EFO Emergency fireman operation	EFS Emergency fireman service	Group Group Control
BMS1 Building monitor port	BMS2 Building monitor RS485	SSML SSM language	CCMS Car chime sound	GSCS Safety shoe & Light screen	AMS Area Monitoring Screen	EPO Emergency Power Operation	NSB Nonstop button
MIT Moderate incoming traffic	MOT Moderate outgoing	MTR Monitoring room connected to the unit					

Available Functions_SOLON 2.0

Standard							
ACP Anti Crime protection	ADO Advanced Door Open	ALARB Alarm bell	ALCOR Advanced Releveling	CCC Cancel error calls	CFT Cafeteria mode	EDP Electronic door protection	CSP Close Torque protection
CUT CALL Block floor	DCBL/ DOBL Door close/open button light	DCP Delayed car protection	DDT Independent car/landing door control	DLM Door lock shortcut measure	DOB/DCB Door open/close button	DTC Door time protection -close	DTO Door time protection -open
ELTU Emergency Light	EN-CCO Call opposition direction cancel	EN-HCC Hall call cancel	ERO Electrical recall operation	FCL Full collective operation	HDI/CDI Hall/Car direction indicator	HPI/CPI Hall/car position indicator	ICU3 Intercom unit
LNS Load non stop	LOBBY Floor of lobby	LR Car light & ventilation	LWS Overload protection	NTSD Near terminal slow down	OHT Drive overheat protection	PKS Parking operation	RLEV Releveling
RE-OP Hall door re-open	RIN Re-initialize	SE Start Equalize	SELF-BTI Self brake torque inspection	SLD Safety landing	TCI Top of car inspection	VSC Voice speech comfort	UCMP Uncontrolled car movement protection

Optional							
ANS Anti-Nuisance	ARO Automatic Rescue Operation	ATT Attendant service	ISC Independent service	DHB Door hold button	EFO Emergency fireman operation	EFS2 Emergency fireman service (manual)	Group Group Control
BMS1 Building monitor port	BMS2 Building monitor RS485	SSM Speech Synthesis Module	CCM Car arrival bell	GSCS Safety shoe & Light screen	AMS Area Monitoring Screen	EPO Emergency Power Operation	EQO Earthquake Operation